

2M SELIG1223 WING

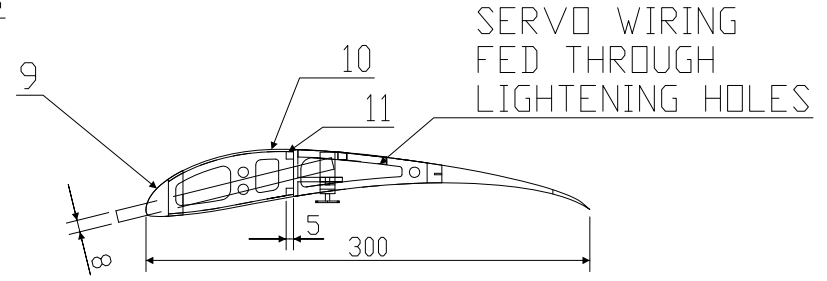

LIGHTENING HOLES ARE USED FOR WEIGHT SAVING WHENEVER POSSIBLE

AILERON

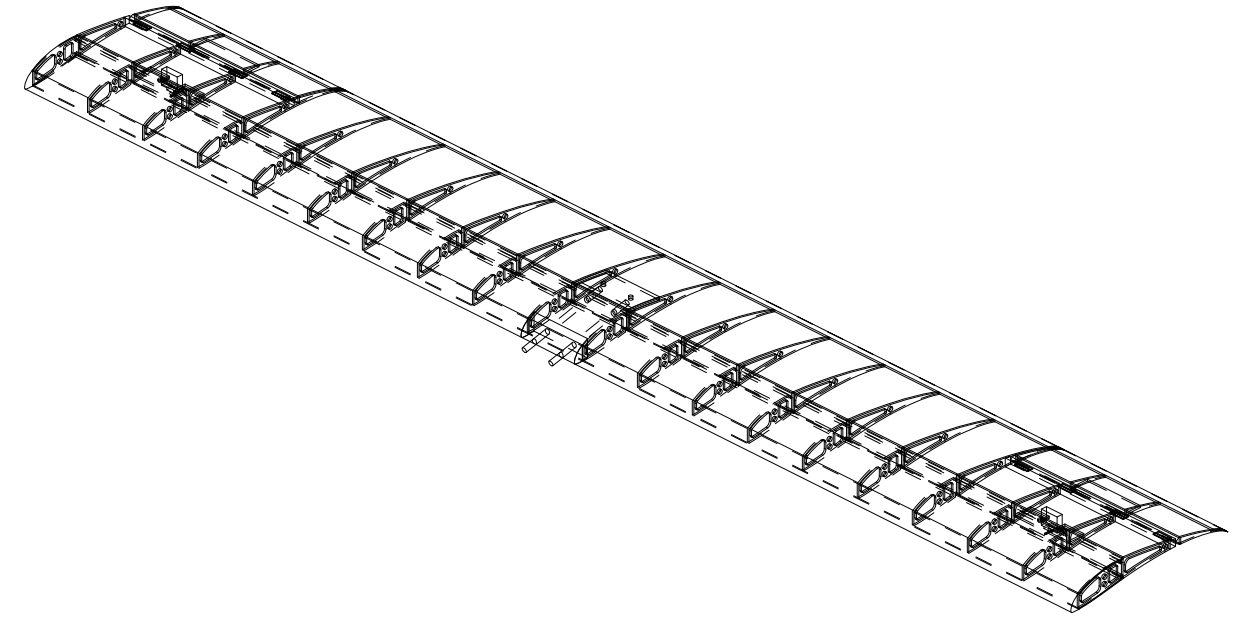
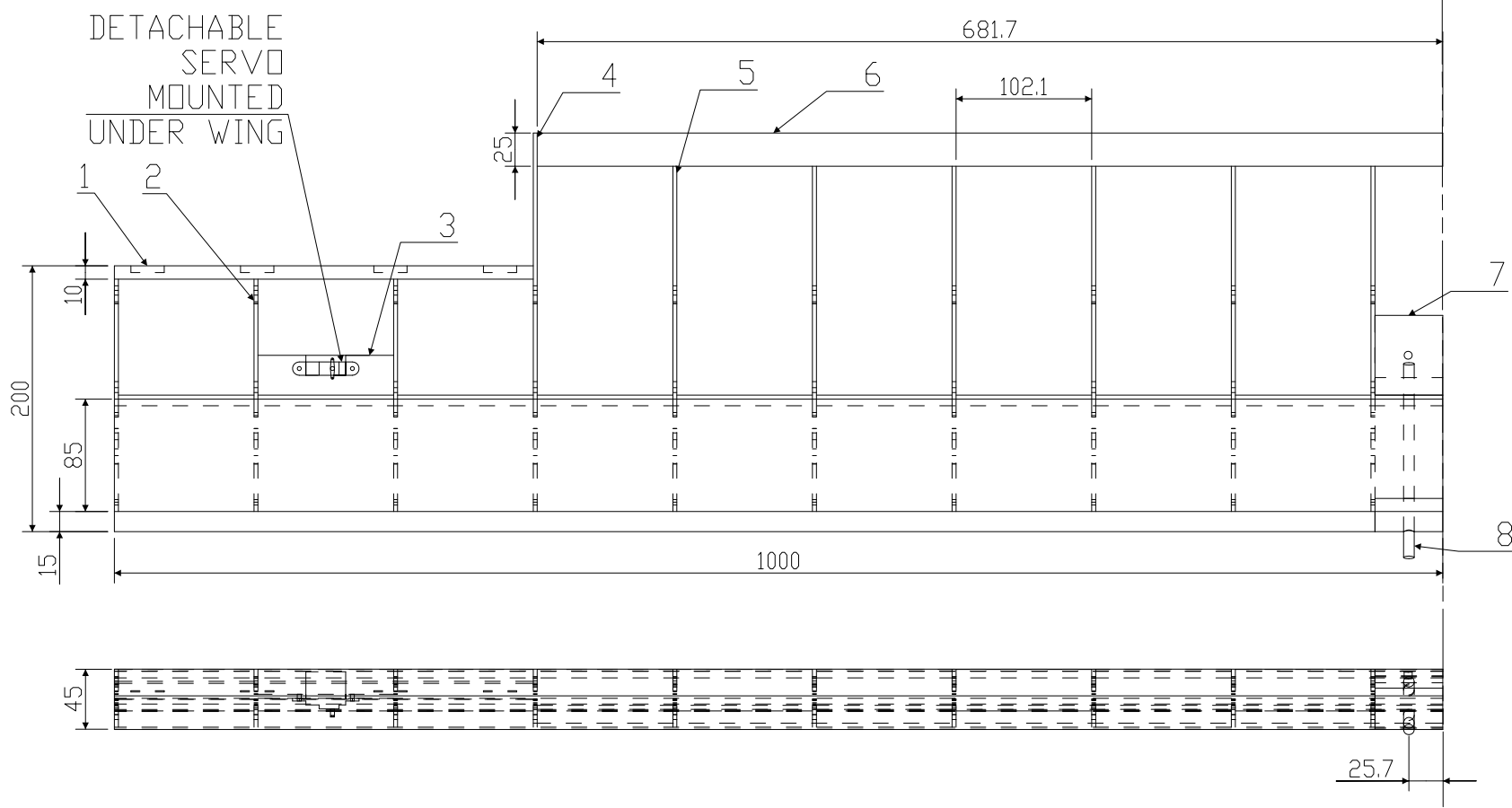
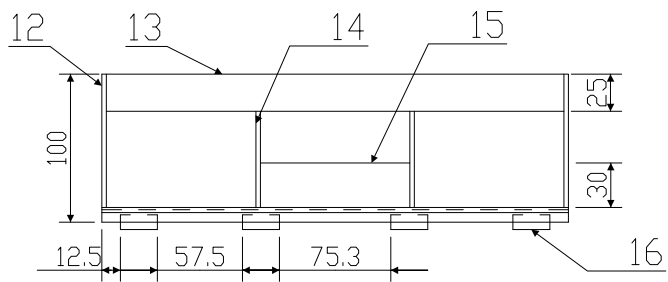

COMPONENTS

WING L/E

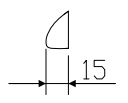

DBOX COVER

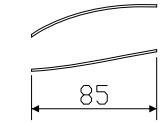

WING BOLT PLATE

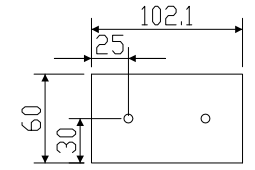

HINGE_A

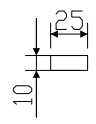

AILERON RIB FULL

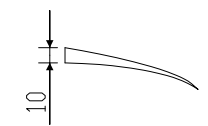

AILERON RIB T-CUT

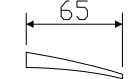

SERVO MOUNT



HORN MOUNT

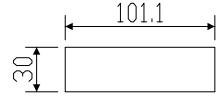

WING RIB FULL

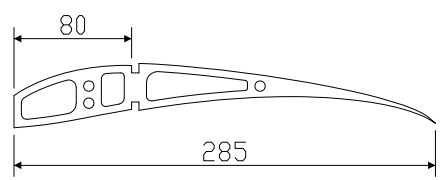

WING RIB T-CUT

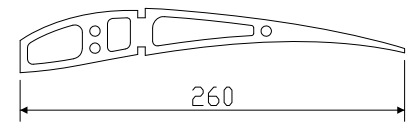

WING RIB A-CUT

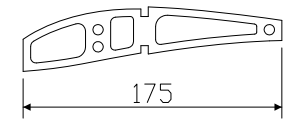

#	PART	QUANTITY	MATERIAL
1	AILERON CS	2	10X10MM Balsa
2	WING RIB A-CUT	6	3MM LITEPLY
3	SERVO MOUNT	2	3MM LITEPLY
4	WING RIB FULL	2	3MM MARINE PLY
5	WING RIB	12	3MM LITEPLY
6	WING T/E	1	3MM Balsa
7	WING BOLT PLATE	1	6MM MARINE PLY
8	WING DOWEL	2	6MM DOWEL
9	WING L/E	1	Balsa
10	DBOX COVER	1	1.5MM Balsa
11	SPAR	2	5X5MM CYPARIS
12	AILERON RIB	4	3MM LITEPLY
13	AILERON T/E	2	3MM Balsa
14	AILERON RIB T-CUT	4	3MM LITEPLY
15	HORN MOUNT	2	3MM LITEPLY
16	HINGE_A	8	1MM PLASTIC

2M SELIG1223 WING ASSEMBLY

BMFA QUANTITY CHALLENGE		STRATHCLYDE UNI - GROUP C Q12	
22/04/2016	PAPER SIZE: A3	SCALE: 0.2	PAGE 2/3
UNLESS OTHERWISE STATED ALL DIMENSIONS IN MM PARTS ATTACHED WITH SUPERGLUE		TOLERANCES ± 0.5 MM	